

J. NEWMAN & N. BROWN.  
Bee-Hives.

No. 136,933.

Patented March 18, 1873.

Fig. 2.

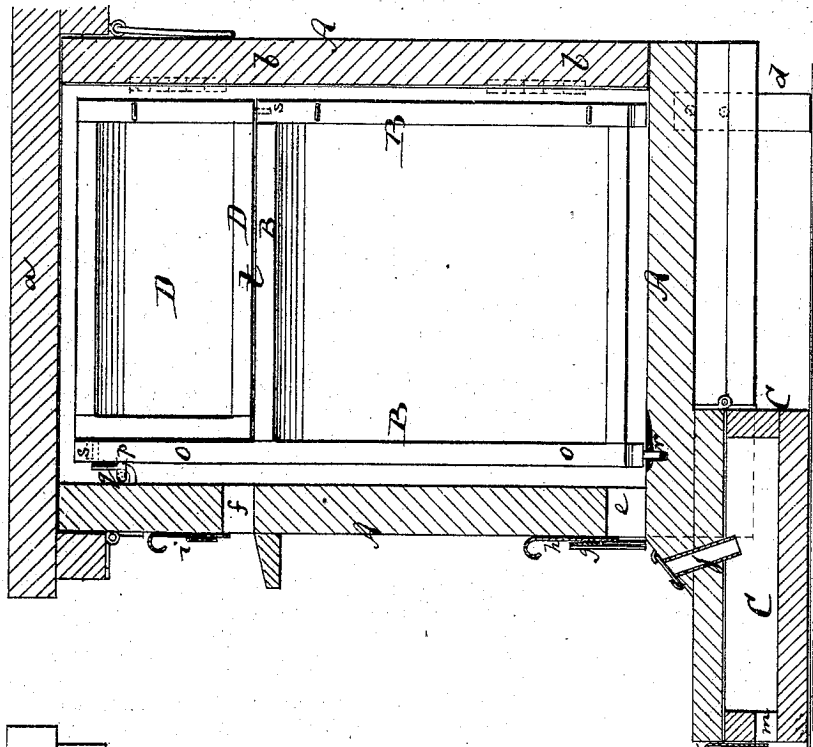
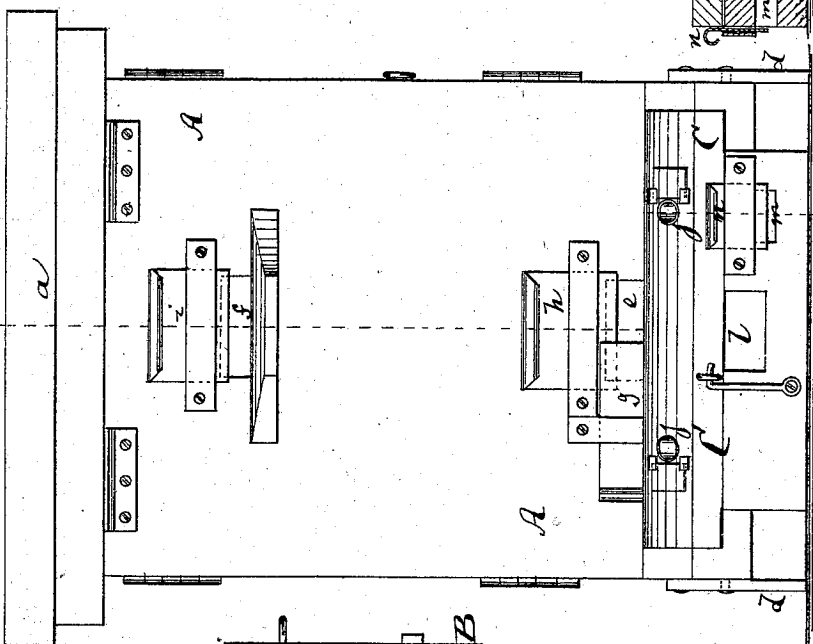

Fig. 1.



Witnesses:

*E. Wolff.*  
*C. Sedgwick*

Fig. 3.

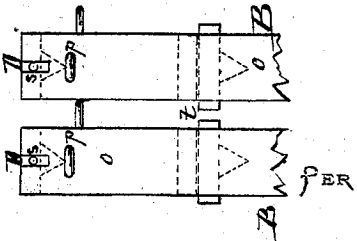

Inventor:

*J. Newman*  
*N. Brown*  
*Munn & Co.*  
Attorneys.

J. NEWMAN & N. BROWN.  
Bee-Hives.

No. 136,933.

Patented March 18, 1873.

Fig. 2.

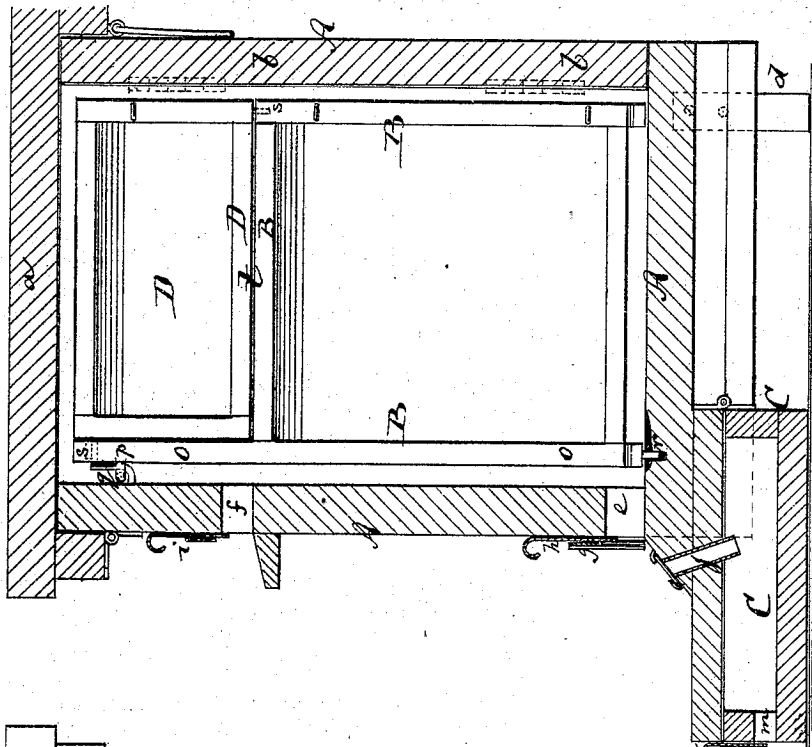
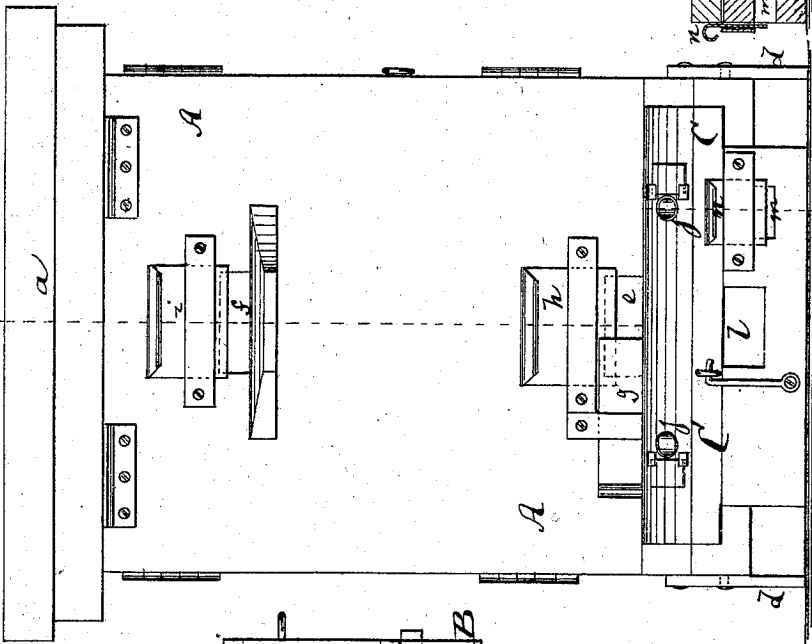

Fig. 1.



Witnesses:

*E. Wolff.*  
*C. Sedgwick*

Fig. 3.

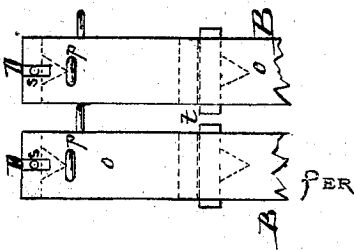

Inventor:

*J. Newman*  
*N. Brown*

*Munn & Co.*  
Attorneys.

tracted, forming narrow throats, through which the working-bees can pass, but not the queen. The latter will thus be effectually excluded from the honey-frames, which will be preserved for the purpose for which they were originally intended. In ordinary hives the queen-bees often enter the honey-frames and deposit eggs therein. The top slat of each of the frames B and D are provided underneath with a small triangular slat for a comb-guide.

Having thus described our invention, we

claim as new and desire to secure by Letters Patent—

The slides or gates *g* and *h* applied to the hive-entrance *e*, to permit the contraction of the same vertically as well as horizontally, as and for the purpose specified.

JOSEPH NEWMAN.

NOAH BROWN. [L. S.]

Witnesses:

EMORY BIRCH,

HUGH A. ALLEN.